

Thermal Master T2 Max QUICK START GUIDE

For content creators only, not for general customers.

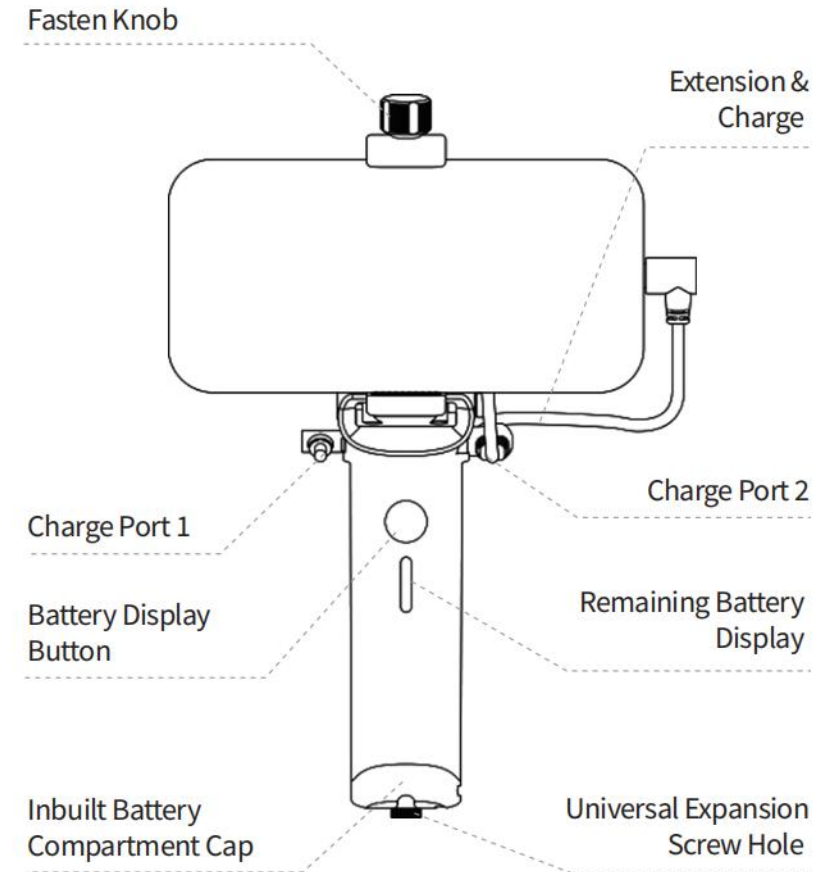

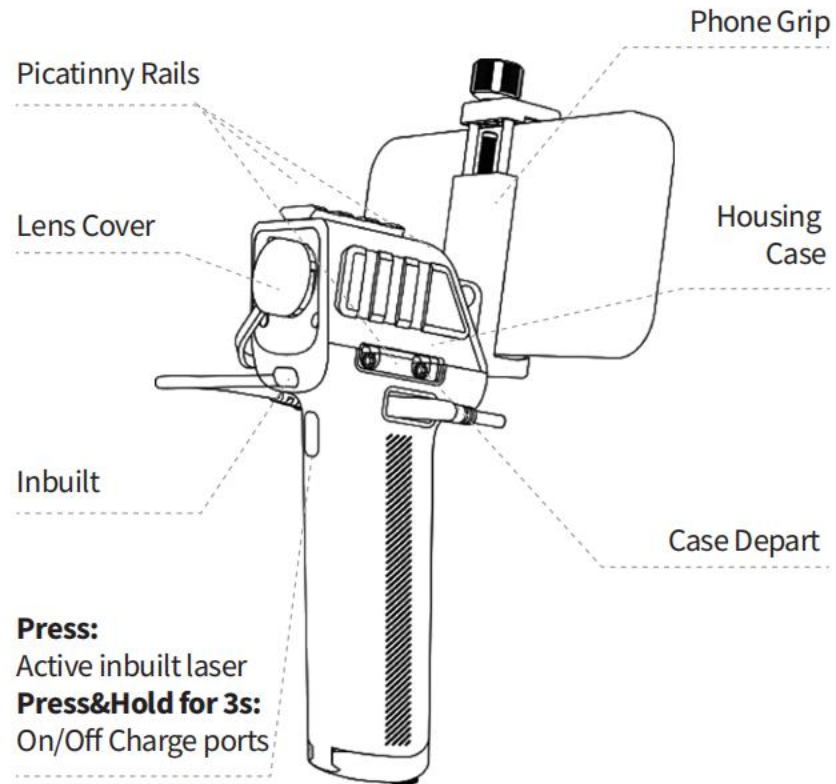



- **Installation and Usage:** Install the screen on the stand, connect ports 3 and 7. Hold button 1 to power on/off or restart.
- **Battery Display:** Press button 4 briefly. The green indicator light in area 5 will illuminate to show the current battery status.



- **Charging the Handle:** Use a Type-C charger to connect to charging port 2. The indicator light in area 5 will blink to indicate charging.
- **Powering the Rangefinder:** Press and hold button 4 for three seconds. The second light in area 5 will turn on. Hold again to turn it off.



- **Turning on the Laser:** Press button 6 briefly to turn on the laser.
- **Powering the Screen:** Hold button 6 for 3 seconds until the first light in area 5 turns on. Hold again to turn it off.
- **Note:** You can charge the handle while simultaneously powering the screen or rangefinder.

How to transfer files from the T2 Max to other devices while using the included screen?

- **Transfer to a phone:** Turn on your phone's Bluetooth, open the T2 Max photo album, select one or multiple files > Share > Connect to the phone's Bluetooth > Wait for the file transfer from the XK550N.



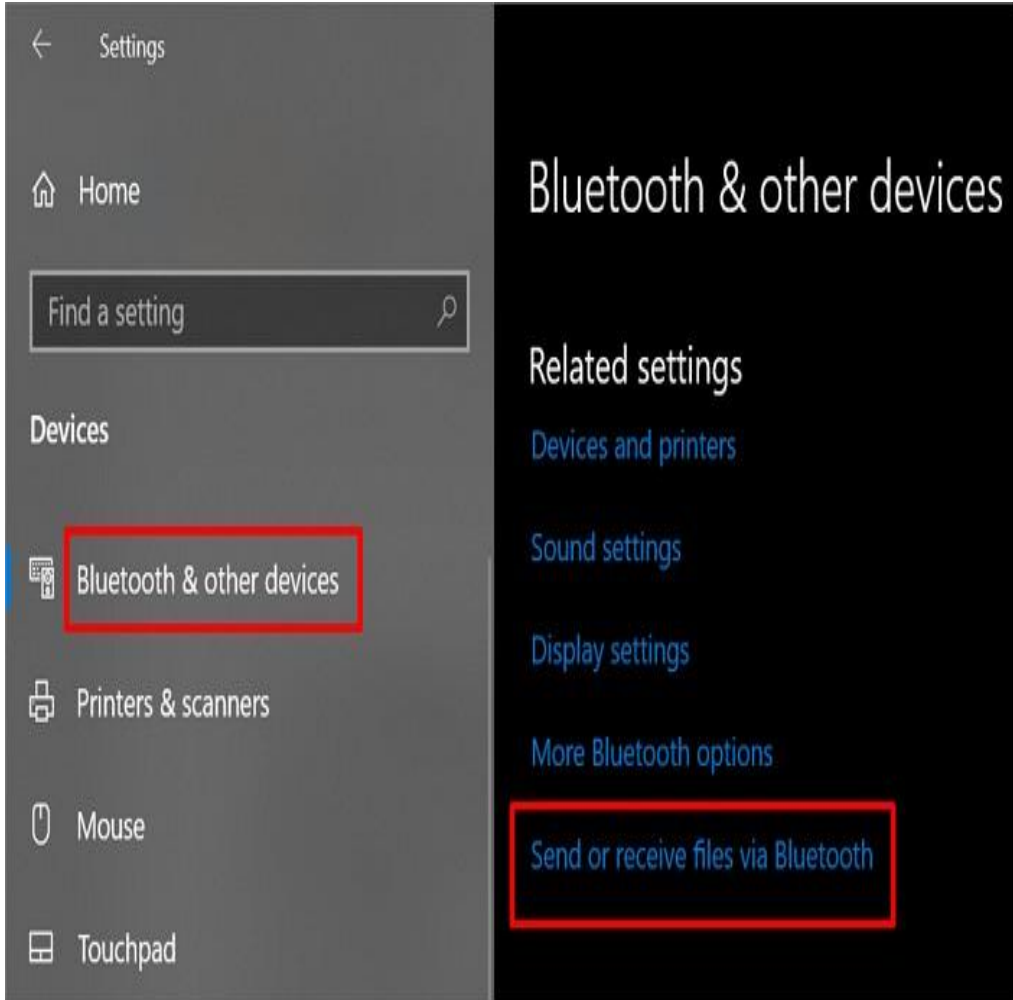

● Transfer to a laptop:

1. Transfer to the phone first, then transfer to the laptop.
2. Go to laptop Settings > Bluetooth & other devices > Devices > Turn on Bluetooth > Scroll down to find 'Related settings' > Select 'Send or receive files via Bluetooth' > Choose 'Receive files'. At the same time, open the T2 Max photo album > Share > Connect to the laptop's Bluetooth > Receive the file from the XK550N on your laptop.

The T2 Max modification reference

- T2 Max Transformers Kit: How to Disassemble, Install on Picatinny Rail, and Explore Its Features.

<https://www.youtube.com/watch?v=uzm-eHIW4bE>

- How to mount T2max on rifle? Two steps: Remove T2max from handle then mount on picatinny rail

<https://www.youtube.com/watch?v=GrsmtH47kIA>

- How to Install the Transformers Kit on a Compound Bow?

https://www.youtube.com/watch?v=GJ_bgkWVmKE